



Adam Elementary Arrival and Dismissal



Dear Parents,

Welcome to Adam! Our administrative team has met with the district transportation, security, and facilities departments to create the following procedures. We feel these procedures will help ensure the safe arrival and dismissal of our Adam students. Please read and follow these guidelines carefully. It will assist us on our "Road to Success!"

Arrival

Walkers/Bike Riders

Students should have a route that they travel each day. Please practice this route with them before August 24. In addition, talk with your student about the arrival time at Adam. Students will be allowed in the building at 8:25 a.m. There is **NO** supervision before school if they arrive early.

Once on the school grounds, walkers and bike riders should enter on the sidewalks on either side of the building. Walkers must stay on the sidewalks until they arrive at the front door. For their safety, walkers should not cross through the parking lots or the parent drop-off area. Bike riders should walk their bikes on the school sidewalks to the bike rack, and enter through the front doors.

Car Rider Drop-off

Morning drop-off will begin at 8:20 a.m. Traffic should enter from Dakar onto Honey Grove Lane, traveling east toward Maxim. Turn **RIGHT** on Maxim and enter the designated car rider lane. **PLEASE** do not turn left from Honey Grove onto Maxim. This disrupts the flow of traffic and may cause a traffic jam. If we all follow this traffic flow, people will be able to move quickly and calmly through the line! Staff will direct traffic once in the car rider lane. When you have come to a complete stop in the lane, students may exit the vehicle, and proceed to the nearest door to the cafeteria. When leaving the car rider zone, please turn left onto Maxim and right from Maxim onto Honey Grove to help alleviate congestion. Parents should remain in their cars at all times. If a parent needs to come into the building, please park in the parking lot and check-in at the front office.

Please be careful not to block driveways to the Adam parking lot or bus zones in the front of the building. Remember that buses have a wide turning radius and need extra room.

Buses

Buses will now use the front circular drive for arrival and dismissal. **Cars should never park in this driveway for any reason.** It is an emergency vehicle zone at times other than arrival and dismissal.

Day Care

Day cares will now use the main parking lot for arrival. Vans will be unloaded at 8:25 a.m. Students will enter the building through the front doors.

Dismissal – We will begin dismissal at 3:45.

Walkers/Bike Riders

To help ensure the safe departure of our walkers and bike riders, they will be dismissed after car riders and bus riders. Students will exit from the side doors near the basketball court. We ask that all students leave the grounds at dismissal. Students walking to the neighborhoods to the east of the school will be escorted along the back of the building and cross Maxim near the cul-de-sac. They may then walk along the grass and continue home. All other walkers should travel through the playground or cross the street at the bridge on Dakar and continue home. Bike riders should walk their bikes until they leave the school grounds, and then continue home.

Car Riders

To help dismissal go quickly and smoothly, while maintaining student safety, we will employ a numbered tag system. Families that will be regular car riders should fill out the car rider form at “Meet the Teacher,” and will be given a set of numbered tags to hang from their rear view mirrors. Many families may arrange carpools, so they should plan on filling out one form together. Each carpool will be assigned the same number so students only need to learn one number.

Parents needing to pick up a student that is not a regular car rider should write the student's first and last name on an 8 ½ x 11 piece of paper in large black letters.

Staff will direct traffic once in the Adam car rider lanes. We will call students from the cafeteria in the order that you have arrived, and have them ready to load in the car rider lanes.

Traffic should follow the same route as in the morning.

Students will not dismiss from the front office after 3:30 or once dismissal begins. Last minute changes create an unsafe environment for our students. If you need to pick up your child from the front office, please plan accordingly.

Day Cares and Buses

Teachers will walk day care riders and bus riders to their designated areas. They will load the students on the appropriate vehicle. Day care vans will load in the parking lot, and all buses will load in the circular bus drive in front of the school.

A map is attached for your review.

We know this is a change for many families. Please be patient as we work out the kinks. Again, our goal is to provide a safe and efficient system for the arrival and dismissal of our 880 Adam Eagles!

Thank you,
Beth May
Principal, Adam Elementary
281-897-4485

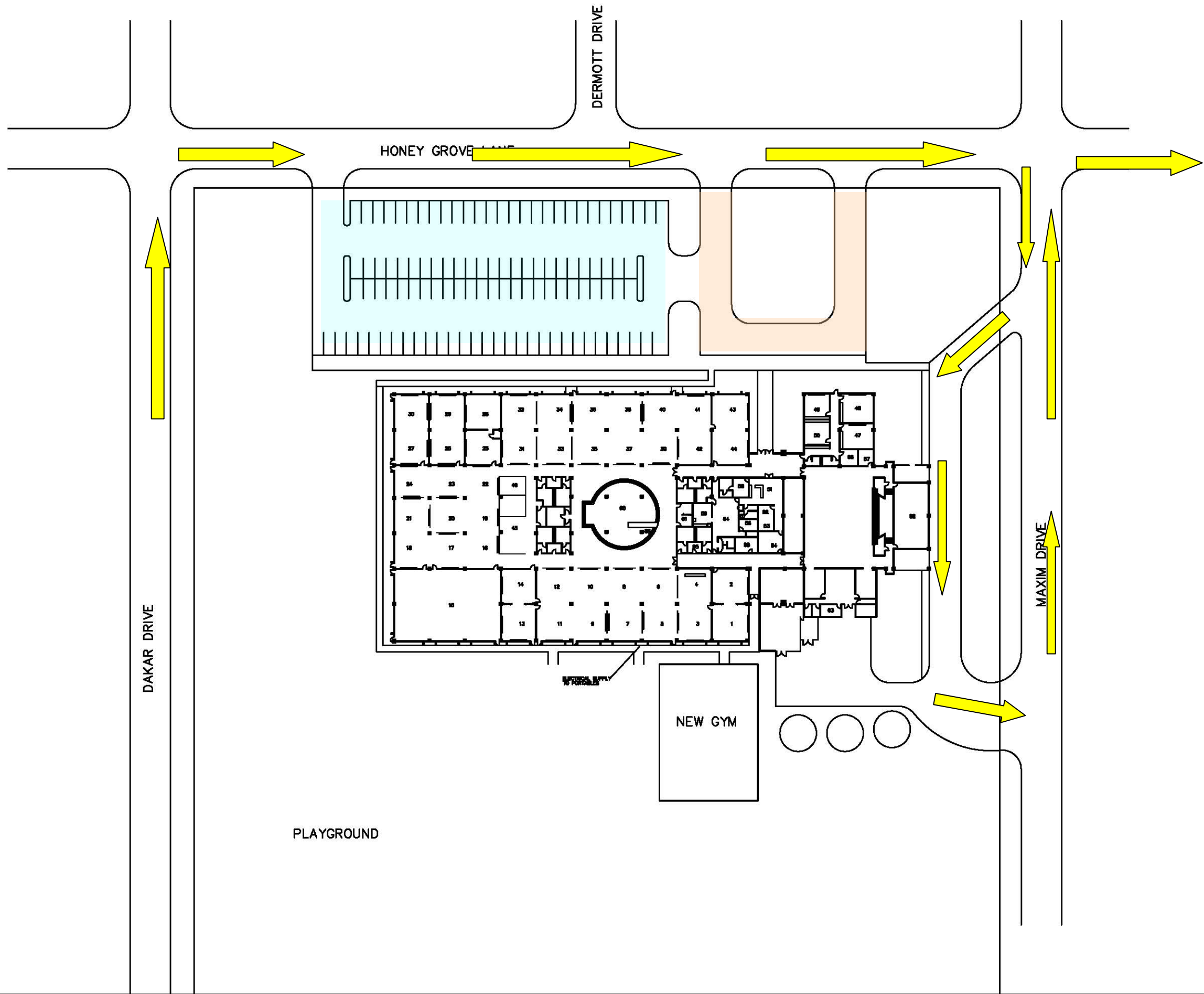

ADAM ELEMENTARY SCHOOL

Transportation Plan 2009-10



scale: 1" = 80'-0"